

# One Piece Top Entry Ball Valves

## Model: TE-1



TRUNNION MOUNTED,  
BI-DIRECTIONAL SHUT-OFF

Sizes:	1.5" to 26" FULL or REDUCED PORT
Pressure Class:	ANSI 150 - 4500 B16.34, API 6A, API 6D, BPVC API 2000 - 15000
Temperature:	(-) 320° F (Cryogenic) to (+) 1500° F (High Temperature)
End Connections:	RF / RTJ / WELD END / HUB END Special ANSI B16.5 / API 6A / ANSI B16.25
Leakage Class:	-API 6D & API 6A - PSL1-3G -API 598 -Bubble Tight (Soft Seated) -ANSI/FCI 70.2 Class V & VI (Metal Seated)
Actuation:	Manual, Pneumatic, Hydraulic, Electric...

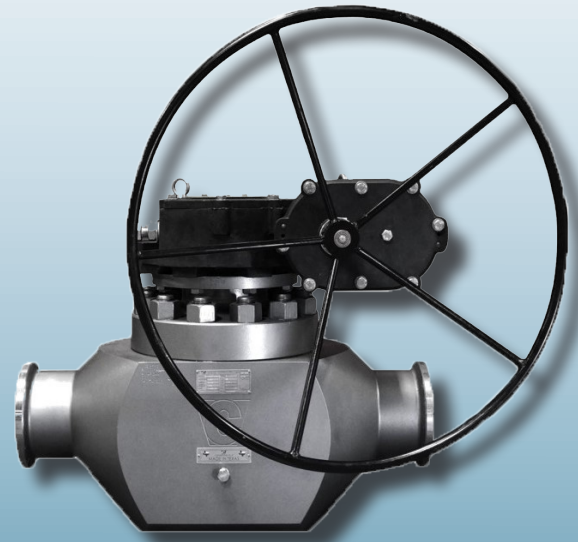

## Standard Features

1. Metal-to-metal body/bonnet seal: reliable and fire safe
2. Solid one-piece ball, stem trunnion designs: Stronger, simpler, and more accurate
3. Pre-loaded, pressure assisted seating, bi-directional seating: no lateral ball movement along flow bore. Pre-loading provides uniform torque. Pressure assistance assures tighter seal.
4. Engineered stem and seat seals per customer specification
5. Trunnion bearing supports: assures alignment and reduce ball/seat torque

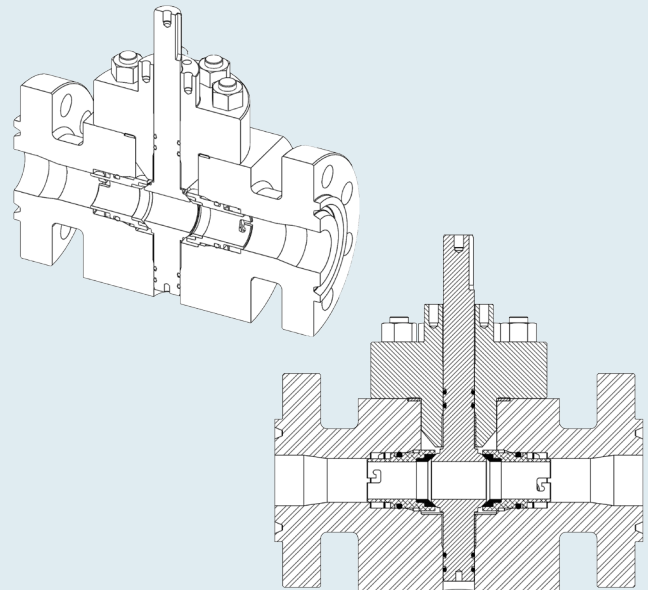

1535 Industrial Drive, Missouri City, TX. 77489  
[www.cornerstonevalve.com](http://www.cornerstonevalve.com)  
(281) 880-8188 [sales@cornerstonevalve.com](mailto:sales@cornerstonevalve.com)



# Model: TE-1

## PARTS LIST

A/R = AS REQUIRED

ITEM	QTY	DESCRIPTION
1	1	Body
2	1	Ball
3	1	Bonnet
4	2	Seat pool (soft or metal)
5	2	Seat insert (soft seat only)
6	2	Seat lock ring (soft seat only)
7	2	Piston Seal (seat)
8	2	Wave spring
9	4	Bearing (stem)
10	4	Stem Seal
11	1	Bonnet Seal
12	A/R	Stud
13	A/R	Nut
14	2	Test Plug

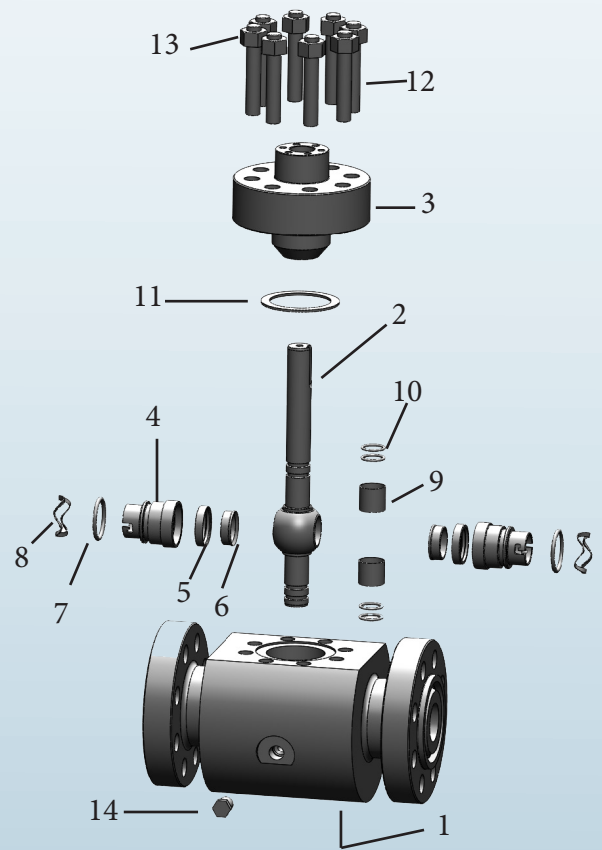

CORNERSTONE VALVE  
CAN ASSIST IN  
SELECTION OF THE  
OPTIMUM MATERIALS FOR  
YOUR SPECIFIC SERVICE.

## Applications

- Oil & gas production natural gas to 15,000 psig
- Crude oil
- Ore slurries
- Steam & condensate
- Cryogenic liquid/gas
- Subsea

## Materials

Carbon Steel, Stainless Steel, Duplex, Chrome, Molybdenum, Nickel & Titanium based alloys and other exotic alloy available upon request.

## Available Options

- Solids proof design
- In-line reparability
- Double block & bleed
- Steam purge ports
- Secondary & Tertiary stem seals
- Soft seated or metal seated
- Various ball coatings
- CRA Overlays
- Firesafe
- Subsea
- Materials to nace standards
- More available, upon request

# CERTIFICATES & LICENSES



API 6A: 0321



API 6D: 0164



API 6DSS: 0073



API Q1: 0165



ISO 9001:2015